

Awards of Excellence

SPONSORS

Event Sponsors



CAT Model Sponsor



Dinner Sponsors

Allegion GC Services
Gardner Builders
RJM Construction

Dessert Sponsors

Empirehouse, Inc.
Maverick Cutting & Breaking
Veit & Companies

Toothpick Sponsor

Carciofini Company

Drink Ticket Sponsor

Sonus Interiors

Photo Booth Sponsor

KOMA

Program & Sign Design Sponsor

Gardner Builders

Program Printing Sponsor

Kraus-Anderson

Sign Printing Sponsor

CES Imaging

Photography Sponsor

Terra Construction

2026 MCA Board of Directors

President

Ryan Klick
Kraus-Anderson

Vice President

Justin Johnson
RJM Construction

Past President

John Petersen
Ryan Companies US, Inc.

Treasurer

Kerry Boyd
John A. Knutson & Co., PLLP

Secretary

Matt Bergmann
Laketown Electric Corporation

Directors

Aaron Abelleira
*Arthur, Chapman, Kettering,
Smetak & Pikala, P.A.*

David Borak
Orion Search Group

Chris Scrabeck
Sonus Interiors

Becca Blake
Doran Companies

Drew Hansen

Leslie Johnson
Empirehouse, Inc.

Avery Wade
Gardner Builders

Adam Winberg
Doran Companies

MCA Staff

Jen Wothe
Executive Director

Jenny Howard
Website & Marketing Manager

Special Thanks to...

Awards Committee

Co-Chair
Kerry Boyd
John A. Knutson & Co., PLLP

Robert Antilla
Brush Masters

Communications Liaison
Avery Wade
Gardner Builders

Co-Chair
Justin Johnson
RJM Construction

Dan Johnson
Allegion

Ryan Schmidt
American Engineering Testing, Inc.

Staff
Jen Wothe
Executive Director

Judges

Deborah Bauknight
LSE Architects

Josh Herzog
Herzog Engineering

Amy Schwabe
TWP Architects

Amy Burkett
ESG Architecture & Design

Adam Meyer
Studio M Architects

Kelle Lang Staats
Kaas Wilson Architects

Basem Hammami
RSP Architects

Gaius Nelson
Nelson-Tremain Partnership

Jill Winkler
TKDA

Colin Oglesbay
D/O Architects

Welcome

Ryan Klick, MCA President

Awards of Excellence Presentation

Justin Johnson, Awards of Excellence Emcee

MCA Choice Award

MCA Choice Award 5-6

- Bloomington Ice Garden (BIG)—RJM Construction

Nominations

New Project Total Value Under \$15,000,000 7-8

- The Forum—Bauer Design Build
- Building Trades Credit Union, Shoreview Replacement and Temporary Location—Donlar Construction
- United Heroes League - Locker Room/Warming House & Precast Stadia—Doran Companies
- Marriott TownePlace Suites - Mankato—Fendler Patterson Construction
- Danny's Construction Multi-Tenant Office Building—Greystone Construction
- Carleton College Class of 1974 Center—Terra Construction

New Project Total Value Between \$15,000,000 & \$50,000,000 9-10

- St. Therese of Corcoran—CBS Construction Services
- Vale Apartments—Doran Companies
- Agralite Electric Cooperative—Gardner Builders
- Black Bear Casino Event Center—Gardner Builders
- Ramsey County Environmental Service Center—McGough
- LaunchPad Golf The Meadows—PCL Construction
- CentraCare Sauk Crossing Clinic Expansion—RJM Construction
- Rowe Residences—Roers Companies
- Carleton College Student Housing—Terra Construction

New Project Total Value Over \$50,000,000 11

- Marvella 2190—Ryan Companies US, Inc.
- Mayo Clinic Health Systems - Mankato Bed Tower Expansion—The Boldt Company

Renovation, Expansion or Tenant Improvement Project 12-13

- Tartan High School Addition & Renovation—Adolfson & Peterson Construction
- Mirabelle—Ancoats
- Restoration of Minnesota Governor's Residence—Donlar Construction
- Donaldson—Gardner Builders
- Fairview Pharmacy Services - Shoreview Seven Lakes Pharmacy—Knutson Construction
- Trillium Woods - Phase 2 Expansion—Kraus-Anderson
- Piper Sandler—McGough
- U.S. Bancorp Center Lobby Reno—Red Cedar Steel
- Minneapolis Police Station 1st Precinct—Ryan Companies US, Inc.
- St. Olaf Hillkitt Renovation—The Boldt Company

Publicly Funded Construction Project 14-15

- Grant County Law Enforcement Center—Adolfson & Peterson Construction
- City of Saint Paul North End Community Center—Donlar Construction
- All Seasons Arena Renovations—Knutson Construction
- Washington County Central Service Center—Kraus-Anderson
- Inver Hills Community College Technology and Business Building Renovation—McGough
- Maple Grove Community Center Renovation & Expansion—RJM Construction
- Byllesby Dam Water to Wire Hydroelectric Project—The Boldt Company

Research, Innovation or Use of Technology 16

- Hansen Cabinets 2.0: Fully Automated Manufacturing Facility—Fendler Patterson Construction
- Bruce Vento Elementary School—RJM Construction
- Carleton College Phiux Certified Student Housing—Terra Construction
- The Standard at Dinkytown—Wells

Subcontractor/Specialty Contractor Project 17-18

- Sick Inc. HQ Expansion – Phase II—Empirehouse, Inc.
- Denver International Airport – Phase 2 of the Great Hall—Grazzini Brothers & Company
- Sick Inc. Bloomington—Infinity Scaffold
- Sofidel—Maverick Cutting & Breaking
- Essentia Health St. Mary's Hospital Demolition—Rachel Contracting

MCA Member Awards 19-20

- General Contractor of the Year
- Subcontractor of the Year
- Construction Service Provider of the Year
- Design Professional of the Year
- Member of the Year

MCA Merch and CAT Model Drawings

SELECTION PROCESS

In each category, judges rated nominations based on general project information, schedule, safety, project management, quality management, cost and risk management, project complexity, innovation and creativity, and customer satisfaction. Both progress and completed work photos were required with each nomination.



**Connect with MCA on
social media and
share your stories
with us!**

Instagram: **@minnesota_construction**

LinkedIn: **Minnesota Construction
Association**

#MCAawards



Bloomington Ice Garden (BIG)

RJM Construction

Originally opened in 1970 as a single-sheet rink, the Bloomington Ice Garden (BIG) has grown into one of Minnesota's premier ice-skating destinations. Over the decades, the facility expanded to three rinks and now supports more than 10,000 hours of annual ice time, hosting dozens of tournaments and welcoming athletes from across Minnesota, the United States, and Canada.

BIG's history is equally impressive. The facility has hosted some of the sport's biggest names, including Olympic and World Champion Dorothy Hamill, NHL Hall of Famer Wayne Gretzky, the U.S. Figure Skating Championships, and the legendary 1980 "Miracle on Ice" Olympic team. Over the decades, the building expanded with additional rinks, upgraded training spaces, and enhanced amenities to meet the growing needs of skaters and spectators, and years of extensive use understandably took a toll on the facility.

To ensure BIG continues its legacy for the next generation, RJM partnered with the City of Bloomington on a transformative \$37.2 million renovation. The modernization replaced the aging ice plant that relied on environmentally harmful R-22 refrigerant and introduced a new roof, state-of-the-art mechanical systems, and fully updated rink floors. Olympic-sized Rink 3 was converted to NHL standards, an indoor training area was added, and locker rooms, restrooms, and ADA-accessible areas were refreshed and expanded.

Executing this renovation required strong leadership and an exceptionally collaborative team process. Under the guidance of RJM Superintendent Jeff Mauder, the project navigated several "undocumented" additions and a series of unforeseen existing conditions uncovered once walls and floors were opened. These challenges demanded rapid design adjustments, immediate pricing from trade partners, and a high level of trust among the owner, architects, and RJM to evaluate solutions quickly and cost-effectively. The team also demonstrated resourceful problem-solving when frost was discovered beneath Rink 2. With the primary testing agency unable to mobilize for several weeks, RJM swiftly secured an alternate partner capable of completing critical soil temperature testing within days, keeping the project on schedule.

Through carefully phased construction, RJM delivered a "2nd miracle on ice" for the city of Bloomington, all within a planned six-month shutdown, ensuring BIG remains a high-performance, high-impact community asset for years to come.





The Forum *Bauer Design Build*

The Forum is a ground-up, modern, multi-use facility combining flexible office space, a fully equipped fitness center with locker rooms and saunas, and entertainment amenities including four indoor pickleball courts and two golf simulators. Together these elements create a community-focused environment that balances productivity, wellness, and recreation.



Building Trades Credit Union, Shoreview Replacement and Temporary Location *Donlar Construction*

Building Trades Credit Union (BTCU) completed construction of a new branch at its historical location on the corner of Rice and I-694 in Shoreview by the end of 2022. The groundbreaking ceremony was held on May 23, 2022. During the construction, a temporary branch was opened in nearby Little Canada.



United Heroes League - Locker Room/ Warming House & Precast Stadia *Doran Companies*

The United Heroes League Locker Room/Warming House & Precast Stadia in Hastings, Minnesota, provides a dedicated space for youth athletes and military families. The facility includes multiple locker rooms, restrooms, a Zamboni room, and elevated stadia seating. It also supported activities during Hockey Day Minnesota 2026.

Marriott TownePlace Suites - Mankato *Fendler Patterson Construction*

Marriott TownePlace Suites - Mankato is a 95-suite extended-stay hotel featuring modern studio and one-bedroom suites with full kitchens, flexible workspaces, and premium finishes. The project includes a fitness center, indoor pool, outdoor patio with firepit and grill, and all supporting infrastructure, creating a welcoming home base for travelers.



Danny's Construction Multi-Tenant Office Building *Greystone Construction*

Greystone Construction developed and built the 28,700SF office building—an inspiring Class-A, two-story facility featuring mass timber, steel, and design by Tushie Montgomery Architects. Located in Shakopee's thriving Canterbury development, it honors Danny's 50-year legacy and craftsmanship, with the company self-performing the steel erection that defines its "Built Strong" spirit.



Carleton College Class of 1974 Center *Terra Construction*

Carleton College's Class of 1974 Center redefines student wellness with a modern hub for health and counseling. Featuring exam rooms, therapy spaces, pharmacy, and advanced systems, it blends accessibility, privacy, and sustainability. More than a building—it's a lasting commitment to student well-being, designed for generations to thrive.





St. Therese of Corcoran ***CBS Construction Services***

A new full-service senior living campus on 13 acres in Corcoran, MN, designed for inclusion within the emerging town center. CBS Construction Services successfully managed construction and coordinated diverse amenities—including a therapy pool, salon, golf simulator, movie theater, library, wellness center, and chapel—while maintaining quality and schedule.



Vale Apartments ***Doran Companies***

Vale Apartments is a 197-unit, 320,951 SF multifamily redevelopment in Minnetonka, MN. The project transforms a former office complex into a Nordic-inspired residential community featuring alcove, one-, two-, and three-bedroom apartments. Amenities include a fitness center, clubroom, entertainment suite, amenity deck, walking trail surrounding a scenic wetland, and more.



Agralite Electric Cooperative ***Gardner Builders***

Agralite's new 65,000 SF office and shop facility in Benson, MN, replaces their previous building. The project supports Agralite's commitment to the local community, prioritizing local businesses and economic impact while providing a modern, functional workspace that allows employees to continue daily operations safely and efficiently throughout construction.



Black Bear Casino Event Center ***Gardner Builders***

Gardner, LSE Architects, and the FDL Tribal Band expanded the Black Bear Casino event center by 20,000 SF. The project added eight new event rooms, a commercial kitchen, and updated common areas, meeting high demand for space and creating a modern venue to host weddings, banquets, and community gatherings.

Ramsey County Environmental Service Center *McGough*

The Ramsey County Environmental Service Center is a modern, efficient facility that expands access to recycling and waste diversion services. Featuring a drive-through drop-off, reuse room, and educational spaces, it enhances community convenience while promoting environmental stewardship and meeting advanced B3 energy-efficiency standards.



LaunchPad Golf The Meadows *PCL Construction*

LaunchPad Golf The Meadows is a 28,000 SF, 40-suite golf entertainment venue featuring premium finishes, indoor and outdoor dining, VIP suites, and a 243-yard driving range with advanced ball tracking. Built by PCL for the SMSC, it combines innovation, sustainability, and cutting-edge design to redefine golf and entertainment experiences.



CentraCare Sauk Crossing Clinic Expansion *RJM Construction*

Expanding CentraCare's Sauk Crossing campus, this project creates a modern, patient-centered environment that brings advanced orthopedic, neuroscience, rehab, imaging, and surgical services under one efficient footprint. The new facilities enhance care delivery, improve flow, and support the region's future health with a thoughtful, community-driven investment.



Rowe Residences *Roers Companies*

Rowe is a mixed-use community in downtown Victoria that blends high-end design with small-town charm. Developed and built by Roers Companies, the project features 125 luxury apartments and 8,700 SF of retail, distinguished by premium finishes and amenities, including a rooftop SkyLounge, speakeasy, and EV-ready underground parking.



Carleton College Student Housing *Terra Construction*

Carleton College's Student Housing project expands equitable living with new housing at Lilac Hill and Union Street—184 beds in sustainable, Phius-certified spaces. Designed for comfort, community, and cultural programs, these residences advance energy efficiency and quality standards while supporting Carleton's goal of 20% townhouse-style living.





Marvella 2190
Ryan Companies US, Inc.

Marvella 2190 expands the Marvella senior living community with 125 independent living units in Saint Paul's Highland Bridge Development. The 276,000 SF building pairs timeless architecture with modern design, supporting active aging in place within an intergenerational neighborhood full of trails, retail, dining, and green space.



**Mayo Clinic Health Systems -
Mankato Bed Tower Expansion**
The Boldt Company

This landmark project for MCHS - Mankato elevates regional healthcare through a transformative 150,000 SF. vertical bed tower expansion directly over their active surgical suite. This expansion creates 120 new patient beds through state-of-the-art surgical suites, critical care units, and maternity units.

Tartan High School Addition & Renovation *Adolfson & Peterson Construction*

This project included multiple additions and renovations, featuring a new stadium, classroom wing, storm shelter gym, science wing, and new main entrance. The existing gym and locker rooms were transformed into flexible learning spaces and a central atrium with a learning stair.



Mirabelle Ancoats

Mirabelle transformed a historic, fully occupied building into a 2,700 SF restaurant that blends coastal ease with vintage elegance. As the fifth project with Jester Concepts and third with Studio Grey, the renovation reflects trusted partnership, careful planning, and a clear vision brought to life in a tight existing space.



Restoration of Minnesota Governor's Residence *Donlar Construction*

The Minnesota Governor's Residence is a 27 room English Tudor home with seven bedrooms, nine bathrooms, two sleeping porches, and eight fireplaces. The Residence contains 14,706 SF and is located on one acre with a 3,420 SF carriage house and garage storage space. Donlar provided asset preservation restoration from interior, exterior, sitework, MEP and security upgrades.



Donaldson Gardner Builders

The Donaldson project transformed 107,000 SF of office space at its Minneapolis headquarters, adding modern conference rooms, labs, and collaboration areas. With energy-efficient upgrades and advanced design, the space fosters innovation, attracts talent, and supports Donaldson's mission to advance filtration for a cleaner, more efficient world.



Fairview Pharmacy Services - Shoreview Seven Lakes Pharmacy *Knutson Construction*

The Seven Lakes Pharmacy in Shoreview houses all departments for Fairview Pharmacy Services, including Specialty, Compounding, Home Infusion, and Integrados. This state-of-the-art facility compounds and distributes necessary medications to all 50 states.

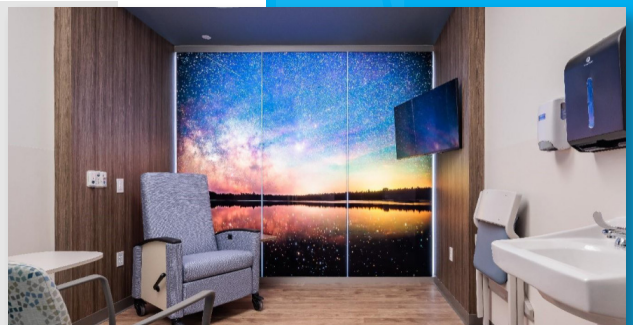



Trillium Woods - Phase 2 Expansion *Kraus-Anderson*

The Trillium Woods - Phase 2 Expansion consisted of a 160,321 SF, five-story expansion with 18 assisted living units, 16 assisted living memory care units, 52 independent living units, and 67 underground parking spaces.

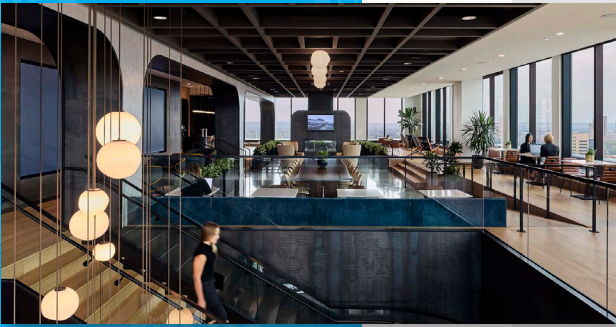

Piper Sandler *McGough*

A high-end corporate office for Piper Sandler located in the North Loop Green building, featuring a trading floor, executive suites, open workspaces, and a rooftop lounge overlooking Target Field. The space blends modern design and performance, reflecting Piper Sandler's identity as a leading investment firm.



U.S. Bancorp Center Lobby Reno *Red Cedar Steel*

The project remodels the U.S. Bancorp Center's first-floor lobby and second-floor skyway areas, updating vestibules, lobbies, corridors, and vacant spaces. The centerpiece of the project is an eloquent spiral staircase.



Minneapolis Police Station 1st Precinct *Ryan Companies US, Inc.*

The Minneapolis Police Station 1st Precinct renovation transformed a historic building into a modern civic facility through close collaboration with Ryan Companies, Swervo, RSP, and the city. Despite urban site challenges and complex existing conditions, the team delivered this adaptive reuse project on schedule with innovative technology and coordinated planning.

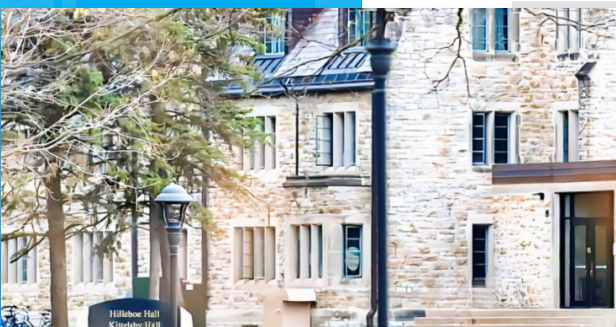

St. Olaf Hillkitt Renovation *The Boldt Company*

Boldt partnered with St. Olaf College to reimagine two adjoining dormitory buildings, transforming them from outdated facilities into vibrant, modern student living environments. The project required complete internal demolition to the structural frame, followed by the installation of state-of-the-art mechanical, electrical, and plumbing systems to ensure long-term efficiency and sustainability.

Grant County Law Enforcement Center *Adolfson & Peterson Construction*

The Grant County Law Enforcement Center is a one-story structure with a basement, featuring a masonry exterior, concrete foundations, and wood framing. There are three holding cells incorporated, with a vehicle sallyport, dispatch, and bookings area for the Sheriff's department. A geothermal system was installed as part of this project.



City of Saint Paul North End Community Center *Donlar Construction*

The North End Community Center is a 25,000 SF building featuring numerous state-of-the-art and sustainable amenities. Sustainable features include a geothermal well field for heating/cooling, a roof-mounted solar array for energy generation, and an underground system for stormwater management with a capacity of 1,000,000 gallons. The building utilizes Cross Laminated Timber beams.



Byllesby Dam Water to Wire Hydroelectric Project *The Boldt Company*

Boldt successfully transformed a century-old hydroelectric facility by demolishing the original 1910 powerhouse, removing outdated equipment, and constructing a modern powerhouse equipped with two new Voith turbines. The project included installation of stop logs, a cofferdam, all site civil works, and high-voltage electrical systems, ensuring reliable energy generation.





All Seasons Arena Renovations *Knutson Construction*

The All Seasons Arena Renovation exemplifies collaboration and innovation, delivering enhanced community spaces and modernized infrastructure. Through strategic planning and teamwork, the team overcame complex challenges to achieve excellence in quality and schedule. This project reflects Knutson's commitment to creating lasting value for Mankato and its residents.



Washington County Central Service Center *Kraus-Anderson*

The two-story, 31,375 SF Washington County Central Service Center is the first fully mass timber building in the county and one of the first in the state, with beams spanning 54 feet over the central atrium and a solar roof. The structure is built for efficiency, durability, sustainability and engagement.

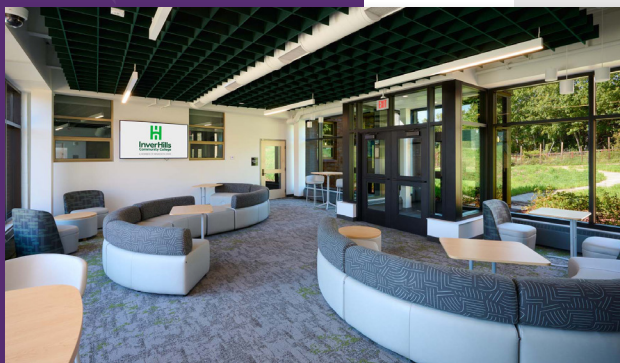

Inver Hills Community College Technology and Business Building Renovation *McGough*

A complete renovation of the Technology and Business Building at Inver Hills Community College, featuring a new roof, enhanced exterior waterproofing, modernized interiors, and a link connecting Heritage Hall. The project introduced new light monitors and structural upgrades to create a brighter, more functional environment for students and faculty.



Maple Grove Community Center Renovation & Expansion *RJM Construction*

The Maple Grove Community Center Expansion transformed a vital community hub with a new ice arena, team spaces, and a modern lobby—all delivered through phased construction while maintaining full operations. The project team's innovation, precision, and collaboration created a state-of-the-art facility that elevates recreation and strengthens community engagement.

Hansen Cabinets 2.0: Fully Automated Manufacturing Facility *Fendler Patterson Construction*

Hansen Cabinets 2.0 is a 92,000 SF, next-generation manufacturing facility built to house one of North America's most advanced automated cabinet production lines. With seven robotics systems and a 400% capacity increase, the project showcases groundbreaking innovation in American manufacturing and commercial construction.



Bruce Vento Elementary School *RJM Construction*

The newly constructed SPPS Bruce Vento Elementary leads the way in environmental education and immersive learning. Replacing the 50-year-old building, this modern facility serves as an enhanced community hub for students. Honoring Congressman Vento, the state-of-the-art school features geo-exchange systems, rooftop solar energy, and repurposed timber from the original structure.



Carleton College Phius Certified Student Housing *Terra Construction*

Carleton College's Student Housing project expands equitable living with new housing at Lilac Hill and Union Street—184 beds in sustainable, Phius-certified structures. Designed for comfort, community, and cultural programs, these residences advance energy efficiency and quality standards while supporting Carleton's goal of 20% townhouse-style living.



The Standard at Dinkytown *Wells*

This housing project showcases a prefabricated building facade system that delivered speed, budget certainty and bold architectural character. Offsite fabrication, integrated windows and insulation, and efficient installation allowed the team to meet a tight occupancy deadline while achieving a dynamic facade and reducing construction risk on a constrained urban site.





Sick Inc. HQ Expansion - Phase II *Empirehouse, Inc.*

Empirehouse designed, engineered, and installed high-performance glazing for Sick Inc.'s HQ campus expansion, including precision curtain walls, pre-glazed units, and an all-glass skybridge. The work enabled a sustainable, state-of-the-art headquarters that drives collaboration, advanced R&D, and innovation—showcasing Empirehouse's expertise in delivering complex, high-performance building envelope solutions.



Denver International Airport – Phase 2 of the Great Hall *Grazzini Brothers & Company*

Grazzini Brothers' scope entailed the installation of over 75,000 SF of large format quartz tile. Work was completed on both Ticketing Level 6 and Baggage Claim Level 5. All work completed was a remodel of existing spaces into a new TSA Checkpoint on Level 6 and new escalator areas.



Sick Inc. Bloomington *Infinity Scaffold*

Infinity Scaffold designed, installed, and dismantled a large-scale, multi-level scaffold system in the expansive atrium of the new Sick Inc. Bloomington Campus. The adaptable design supported multiple trades simultaneously. It provided full perimeter and ceiling access for finishing work on structural beams, sky lights, and slab edges.

Sofidel
Maverick Cutting & Breaking

The project consisted of selective structural demolition, concrete rehabilitation, including slab and anchor repair, associated with the future facility expansion.



**Essentia Health St. Mary's
Hospital Demolition**
Rachel Contracting

The Essentia Health St. Mary's Hospital Demolition Project encompassed the safe abatement, demolition, site restoration of a 12-story, 648,000 SF facility in downtown Duluth. Highlights included environmental remediation, removal of three skywalks & a 110-foot chimney, followed by backfill, new utilities, lighting, landscape restoration, and transforming an entire city block for future redevelopment.



MCA Member Awards

Each year, the Minnesota Construction Association honors member companies that make significant contributions to both the community and association. The MCA General Contractor, Subcontractor, Design Professional, and Service Provider of the Year candidates are companies that are current members. Winners are selected through a People's Choice voting process at the end of each year. All members in good standing are given the opportunity to vote for the candidate of their choice.



Previous **General Contractor of the Year** Recipients:

- 2025 | Knutson Construction
- 2024 | Ryan Companies US, Inc.
- 2023 | Kraus-Anderson
- 2022 | McGough
- 2021 | Greystone Construction Company



Previous **Subcontractor of the Year** Recipients:

- 2025 | Sonus Interiors
- 2024 | Frattalone Companies
- 2023 | Quad E. Companies, Inc.
- 2022 | Wells
- 2021 | Rachel Contracting



Previous **Design Professional of the Year** Recipients:

- 2025 | KOMA
- 2024 | Emanuelson-Podas
- 2023 | KFI Engineers
- 2022 | Civil Site Group
- 2021 | BKBM Engineers

Previous *Service Provider of the Year* Recipients:

- 2025 | American Engineering Testing, Inc.
- 2024 | CES Imaging
- 2023 | Braun Intertec Corporation
- 2022 | Orion Search Group
- 2021 | SitesForBuilders.com

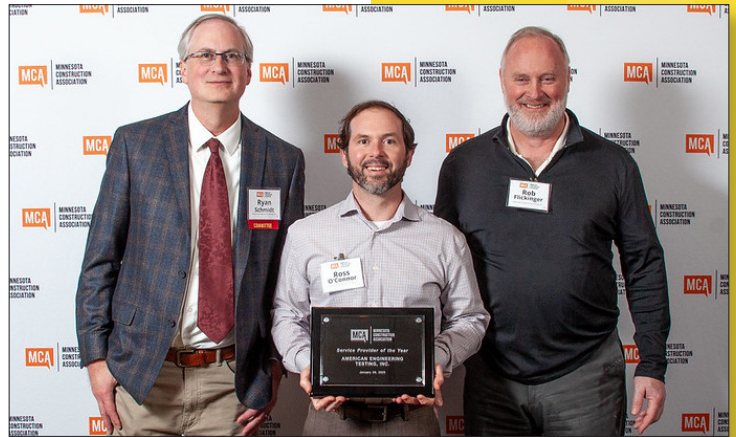

MCA Member of the Year

Members are encouraged to nominate fellow members who deserve special recognition. Each year, we look for a member who demonstrates a commitment to MCA and its growth, is active in the association, and has contributed to the success of ongoing or recently completed construction projects. This award celebrates a member whose dedication and collaborative efforts make a lasting impact on the MCA community.

Previous *MCA Member of the Year* Recipients:

- 2025 | David Borak
- 2024 | Dave Lyste
- 2023 | Paul Kolas
- 2022 | Grant Tentis
- 2021 | Patrick North



2026 MCA Board of Directors



President **Ryan Klick** **Kraus-Anderson**

Ryan has been with Kraus-Anderson since 2009 and is the Construction Executive overseeing the commercial market sector. He has managed more than \$600 million in construction projects across five states. Ryan focuses on building collaborative teams and delivering efficient, safe, and high-quality solutions for every project. He has been an active member of MCA for seven years, helping establish the Student Outreach Mentorship Program and coordinating Leadership Training Academy events. Ryan has served on the MCA Board of Directors for six years and is currently the President. Outside of work, Ryan enjoys spending time at the lake with his wife Jodi and their three children—Quinn, Hazel, and Reese.



Vice President **Justin Johnson** **RJM Construction**

Justin is the Corporate Market Sector Lead at RJM Construction. He has been with RJM for 18 years, starting his career in preconstruction and now overseeing RJM's Corporate market. His motivated, task-oriented approach sets a high standard for the team as he fosters long-term client relationships and brings project visions to life. Justin has been an MCA member for over 10 years. He continues to be active within MCA due to the relationships built through the years and looks to give back to the construction community through the exciting events MCA offers. Outside of work, Justin enjoys spending time with his wife, Jenny, and his kids (an 11-year-old boy and an 8-year-old girl). He coaches his kids in sports and enjoys golfing, traveling, and listening to vinyl records.



Treasurer **Kerry Boyd** **John A. Knutson & Co., PLLP**

As a tax manager at John A. Knutson & Co., PLLP, Kerry helps clients solve their tax issues. He joined JAK in 2025 and brings 20+ years of public accounting experience to his role. Kerry specializes in the Construction/Real Estate and Professional Service niche groups. He initially joined MCA through his firm's outreach efforts to give back to CRE associations and became involved with the Awards Committee in 2018, remaining active ever since. Kerry values the networking opportunities and the chance to help grow the association as it builds toward the future. Outside of work, Kerry coaches traveling baseball for his son and enjoys watching his twin daughters participate in sports. His family stays busy, with all three children playing hockey. Kerry enjoys reading, watching movies, and attending Wild games.



Secretary
Matt Bergmann
 Laketown Electric Corporation

As CEO of Laketown Electric Corporation, Matt oversees both the Waconia and Mankato branches, providing oversight over every department, ranging from project management to human resources to financial oversight and much more. LEC is a seven-time Inc. 5000 honoree, and Matt was recognized as one of five "Most Admired CEOs" by the Minneapolis St. Paul Business Journal in 2026. LEC joined MCA over 10 years ago to connect with like-minded construction leaders and deepen relationships with customers. Matt values the camaraderie and networking opportunities with industry peers, considering them one of the most rewarding aspects of the association.



Past President
John Petersen
 Ryan Companies US, Inc.

Since 2021, John has served as Vice President of Preconstruction, leading Ryan Companies' national housing sector. In this role, he drives the preconstruction process and ensures consistency across all housing projects in Ryan's nine national regions. A longtime MCA member since 2002, John initially became involved by attending events to represent his company, but quickly recognized the value of the people within the organization. He believes the networking, fellowship, and mentorship opportunities are invaluable, with MCA events providing a welcoming environment to connect with peers and stay informed on industry innovations. John has chaired the MCA Sporting Clay Committee since 2019. Outside of work, John enjoys spending time with his wife and two daughters (21 and 15) at their property near North Branch, MN.



Director
Aaron Abelleira
 Arthur, Chapman, Kettering, Smetak & Pikala, P.A.

Aaron is a shareholder at Arthur, Chapman, Kettering, Smetak, & Pikala in Minneapolis, Minnesota, who focuses his practice primarily on Construction Law, bringing a unique combination of legal knowledge and hands-on industry experience to his clients. Before embarking on his legal career, he spent a decade in the trades as a commercial roofer, giving him a perspective on the challenges faced by the construction industry. Aaron started his involvement with MCA by serving on the Clay Shoot Committee. He values the relationships he has built with fellow MCA members and looks forward to continuing to serve on the Board of Directors. In his free time, Aaron enjoys spending time with his wife and children, playing drums in a punk rock band, and playing disc golf.



Director

David Borak
Orion Search Group

David has been a Principal with Orion Search Group since 2005, specializing in recruiting for the construction, engineering/architecture, and real estate development industries. As a member of MCA for the past eight years, he joined to help support the Minnesota construction industry, finding the networking and educational sessions extremely valuable. David lives in Eagan with his wife and two children. In his free time, he loves watching and playing golf and basketball.



Director

Becca Blake
Doran Companies

Becca is a Senior Project Coordinator at Doran Companies, where she has worked for nearly nine years. In 2026, she officially joined the MCA as a board member after being heavily involved in the annual Clay Shoot event. After enjoying the experience and the opportunity to connect with others, she decided to take on a more active role and continue building relationships within the organization. Outside of work, Becca is a busy mom of two. Her family stays active and travels annually to their favorite spot in Costa Rica. She loves watching her oldest son, Denny, dive into new interests like hockey and baseball, and even join his dad in the deer stand.



Director

Drew Hansen

Drew has 20 years of experience in the construction and engineering industries, where he has focused on delivering meaningful results for clients and stakeholders. He thrives both as an independent contributor and a collaborative team member and is committed to continuous personal and professional growth. Drew joined MCA seven years ago to expand his network and stay ahead of industry trends. He values the strong community, educational opportunities, and events that foster professional growth and meaningful connections. Outside of work, Drew enjoys traveling, staying active through fitness, volunteering, spending time outdoors, and exploring new interests.



Director

Leslie Johnson
Empirehouse, Inc.

Leslie has worked as a sales manager at Empirehouse, Inc. for eight years. She has been active in MCA for over four years, serving on the Events Committee. Being an MCA member has allowed her to build meaningful relationships/ friendships, and partnerships within the construction industry. In her free time, Leslie likes walking her dog and playing with him around the house. She also enjoys remodeling their home, ice fishing, game nights with her husband, spending time with friends and family, cooking, gardening, and reading a good book in her happy place on the patio swing in the backyard.



Director
Chris Scrabek
Sonus Interiors

Chris is the Director of Operations for the Ceiling Division at Sonus Interiors, overseeing divisional strategy and project management. He joined MCA eight years ago to leverage the organization's networking and professional development resources. Chris finds significant value in exchanging insights with industry peers, particularly regarding operational efficiency and navigating the challenges of an evolving market. Outside of work, he stays busy raising his four young children.



Director
Avery Wade
Gardner Builders

Avery is the Marketing Proposal Specialist at Gardner Builders, where she creates proposals that meet client needs and reflect Gardner's brand. She entered the construction industry in 2021 after graduating from college, but her journey started much earlier. At 16, she worked as an office assistant for a local contractor, sparking her career. She didn't plan on working in construction, but now she loves every part of it. Avery joined MCA's Communications Committee in 2022 and now serves as chair and communications liaison for the Awards Committee. She is also helping launch the Emerging Professionals Committee to support future industry leaders. Outside of work, Avery enjoys spending time outdoors—whether it's boating, catching a baseball game, or hanging out at a patio happy hour.



Director
Adam Winberg
Doran Companies

Adam is a Preconstruction Manager at Doran Companies. He collaborates with architects, engineers, estimators, PMs, and developers to manage design, vet proposals, coordinate with subs, and oversee schedules, timelines, and budgets. Adam's first MCA event was the Awards of Excellence in 2013! Adam finds the opportunities to connect with industry professionals to be the most valuable aspect of MCA. With dynamic events and social gatherings, MCA is a great way to meet others in the industry who have similar goals and interests. In his free time, Adam enjoys camping with his wife (Anna) and kids (Peyton & Ethan), as well as spending time with friends and family. He also enjoys the outdoors, coaching/watching his kids in various sports, and Vikings games.

Adolfson & Peterson Construction
 All In One Accounting
 Allegion- North Central RSO
 Allied Blacktop Company
 American Engineering Testing, Inc.
 Ames Construction
 Ancoats, LLC
 Apex North Business Coaching
 Arthur, Chapman, Kettering,
 Smetak, & Pikala, P.A.
 Atlas Foundation Company
 Automated Logic
 Bauer Design Build
 Bay West LLC
 Bituminous Roadways, Inc
 BJ Baas Builders, Inc.
 BKBM Engineers
 Braun Intertec Corporation
 Brin Glass Company
 Brush Masters
 Builders & Contractors Workers'
 Compensation Fund
 Capital One Business
 Carciofini Company
 Carl Bolander & Sons
 CBS Construction Services
 CES Imaging
 Civil Site Group
 Clean Response
 CliftonLarsonAllen LLP
 CNC Foundations
 CohnReznick
 Commercial Drywall, Inc.
 Common Links Construction, LLC
 Construction Support Services, Inc.
 Darcy Solutions Inc.
 Dem-Con Companies
 Dering Pierson Group
 Diversified Construction
 Donlar Construction Company
 Doran Construction
 DWELL 44- A Modern Design
 Showroom
 Egan Company
 Emanuelson-Podas
 EMC Insurance Company
 Empire Concrete Cutting & Coring
 Empirehouse, Inc.
 Enterprise Fleet Management
 EPS- Environmental Plant Services
 ERoof, LLC
 ESi
 EvoTek
 Fabyanske, Westra, Hart &
 Thomson, P.A.
 Fehn Companies
 Fendler Patterson Construction
 Fisher, Bren & Sheridan, LLP
 Frattalone Companies, Inc.
 Frontier Precision, Inc.
 G4 Construction Management
 Gage Bros. Caulking, Inc.
 Gardner Builders
 Gephart Electric
 Grazzini Brothers & Company
 Greiner Construction
 Greystone Construction Company
 H+U Construction
 Hansen Auction Group
 Hardscape Construction
 Herzog Engineering, LLC
 Holmes Murphy Construction
 Homeco Insulation
 IFS
 Infinity Scaffold
 InFORM Financial Planning
 INSPEC, Inc.
 ISG
 JE Dunn Construction
 John A. Knutson & Company
 JT EGNER Construction
 JTH Lighting Alliance
 Kaas Wilson Architects
 Kellington Construction, Inc.
 Kline-Johnson & Assoc.
 Knutson Construction
 KOMA
 Konik
 Kraft Mechanical
 Kraus-Anderson
 Kremer Davis, Inc.
 KW Specialty Services LLC
 LaForce LLC
 Laketown Electric Corporation
 Loeffler Construction & Consulting
 LRS/Atomic Recycling
 Mansfield Service Partners
 Market & Johnson
 Marsh McLennan Agency
 Maverick Cutting & Breaking
 Mavo Systems
 McGough
 MEI Total Elevator Solutions
 Meyer Contracting
 Modern Piping, Inc. DBA Modern
 Molin Concrete Products Company
 Mr. Spring LLC
 National American University
 Neaton Brothers Erosion LLC
 Nor-Son Construction
 North Haven Design Build
 North Starz Underground LLC
 Northwestern Surveying and
 Engineering
 Olympiatech Electric
 Orion Search Group
 PCL Construction
 Peterson Sheet Metal
 Philadelphia Surety
 Pioneer Golf Company
 Purple Wave Auction
 Quad E Companies, Inc.
 Rachel Contracting
 Ram Construction Services
 Ramsey Companies, Inc.
 Rapids & Affiliates
 Red Cedar Steel Erectors, Inc.
 Redpath and Company
 RJM Construction
 Rochon Corporation
 Roers Companies
 Ryan Companies US, Inc.
 Scaffold Service
 Schreiber Mullaney Construction
 Shaw-Lundquist Construction
 Shine Wealth
 Signature Systems
 SitesForBuilders.Com
 Sompo
 Sonus Interiors
 Steiner Construction Services, Inc.
 Stonewing Builders, Inc.
 Stoneworks
 Structures, Inc.
 Subsurface Constructors Inc.
 Sun Control of MN
 SwedeBro
 T.Scherber Demolition, Excavating,
 Roll-Off
 Terra Construction
 Terracon Consultants, Inc.
 The Boldt Company
 The Concrete Guy
 The Whiting-Turner Contracting
 Company
 TMI Coatings
 TrueBuild Solutions
 Twin Cities Siding & Roofing
 U.S. CAD An ARKANCE Company
 US Compliance
 Veit & Company, Inc.
 Versacon Inc.
 Vic's Crane & Heavy Haul, Inc.
 WA Group
 Wells
 Wipfli LLP
 WTG Terrazzo & Tile, Inc.
 Zachary Construction



The Minnesota Construction Association is a nonprofit organization that fosters education, recognition, and networking for students and industry professionals. We are dedicated to helping students graduate, connect with industry professionals, and shape their careers.

Visit mnconstruction.org/student-outreach to learn more!

Congratulations to the 2025-2026 recipients of the MCA Annual Scholarships! Funds are raised from our members at various events throughout the year, including our Annual Golf Tournament and Annual Sporting Clay Event.

Since 2011,
MCA has awarded
\$125,750 in scholarship funds to 71 students at 19 different colleges
to help achieve their education goals.



Isabelle Snyder
North Dakota State University



Anthony Alioto
Minnesota State University, Mankato



Abigail Bristow
South Dakota State University



Grant Warkenthien
Minnesota State University, Moorhead



Donavon Ohms
University of Minnesota, Twin Cities



Brady Braun
University of North Dakota



Elana Hanson
Minnesota State Community & Technical College



Ayden Froeschle
Dakota County Technical College (DCTC)



Brian Imholte
St. Cloud Technical & Community College



Ashkan Kaftoosian
Saint Paul College

MCA had a busy year and **accomplished amazing feats** with the help of our volunteers and members!



In 2025, MCA . . .

- Raised over \$28,000 in annual sponsorships!
- Proudly welcomed 30 new company members and 57 new student members!
- Hosted events for new and emerging construction professionals (10 years of experience or less) to help build connections!
- Surpassed 4,000 followers on LinkedIn, achieving an impressive 21.7% growth, while our Instagram audience grew by 26.5%, boosting our overall digital engagement!
- Restructured our Leadership Training Academy, for a fun-filled day of networking with industry leaders, engaging in competitive & developmental activities!
- Once again sold out our larger annual golf tournament, making it the most successful one yet!
- Had our largest Sporting Clay event since it first began in 2018!
- The Student Outreach Committee visited 5 colleges, fostering connections and inspiring future industry leaders!
- Received 63 scholarship applications and awarded 10 scholarships, totaling \$21,250!

SUBMIT CONTENT FOR OUR NEWSLETTER



Share your content! **Leverage your membership by sharing your company's story.** We make it easy for you to celebrate accomplishments with your fellow members.

Visit mnconstruction.org/newsletter for guidelines and more information.



Save the Dates

■ EDUCATION ■ RECOGNITION ■ NETWORKING

Meet the Estimators (co-hosting with MSA and MBEX)

Wednesday, February 4, 2026

Education Session: Introduction to Target Value Delivery

Thursday, February 12, 2026

Education Session: AI Adoption in Construction

Tuesday, April 14, 2026

Leadership Training Academy

Thursday, April 23, 2026

Education Session: Busting Through Growth Ceilings: 3 Strategic Levers to Accelerate Organizational Growth

Tuesday, May 5, 2026

Annual Golf Tournament

Wednesday, June 3, 2026

Education Session: Crisis Management in Construction, A Panel Discussion

Wednesday, September 9, 2026

Annual Member Celebration

TBD October

Annual Sporting Clay Shoot

Wednesday, October 21, 2026

Construction Industry Forecast: The State of the Minnesota Economy

Thursday, November 5, 2026

MCA has a great lineup of events planned for 2026. Mark your calendars now and visit mnconstruction.org for additional details and to register.

Thank You FOR YOUR SUPPORT!



ALLEGION™

Carciofini



DARCY®
Sustainable Heating and Cooling



GARDNER

KOMA
ARCHITECTS | DESIGNERS | ENGINEERS

K A KRAUS-ANDERSON®



McGOUGH

RACHEL



RYAN

SONUS
INTERIORS

Terra®
CONSTRUCTION

VEIT®

*Thank you for joining us and to all of our generous
sponsors for making this event possible!*